

LEGEND

- ◇----- ORIGINAL GOVERNMENT CORNER SEARCHED FOR - NOT FOUND
- ◆----- ORIGINAL GOVERNMENT CORNER FOUND
- ◆----- FOREST SERVICE CORNER
- ◆----- STANDARD B.L.M. CORNER
- ◆----- STANDARD D.W.R. CORNER
- ◆----- STANDARD BUTTE CORNER - 2" IRON PIPE AND BRASS CAP
- CORNER MONUMENT - NO HISTORY - SHOWN ON RECORD MAP
- CORNER MONUMENT - NO HISTORY
- ORIGINAL CORNER MONUMENT - SHOWN ON RECORD MAP
- ①----- PROPORTIONED CORNER SET BY SURVEYOR - SHOWN ON RECORD MAP
- ①----- CORNER MONUMENT SET BY SURVEYOR - NOT SHOWN ON RECORD MAP
- CORNER SEARCHED FOR NOT FOUND - DATE OF SEARCH
- 
- 

NOTES

- 32-PH-25 ----- BOOK 32 OF PARCEL MAPS PAGE 25
- 32-RS-25 ----- BOOK 32 OF RECORD OF SURVEY MAPS PAGE 25
- 32-~~PH~~-25 ----- BOOK 32 OF MAPS (SUBDIVISION) PAGE 25
- 114-FB-25 ----- BOOK 114 PAGE 25 OF COUNTY SURVEY FIELD NOTES
- C-506 ----- MAP ON FILE PUBLIC WORKS DEPARTMENT
- CR ----- CORNER RECORD FILED
- PS ----- PRIVATE SURVEYORS INFORMATION
- M.O.R. ----- MOUND OF ROCKS

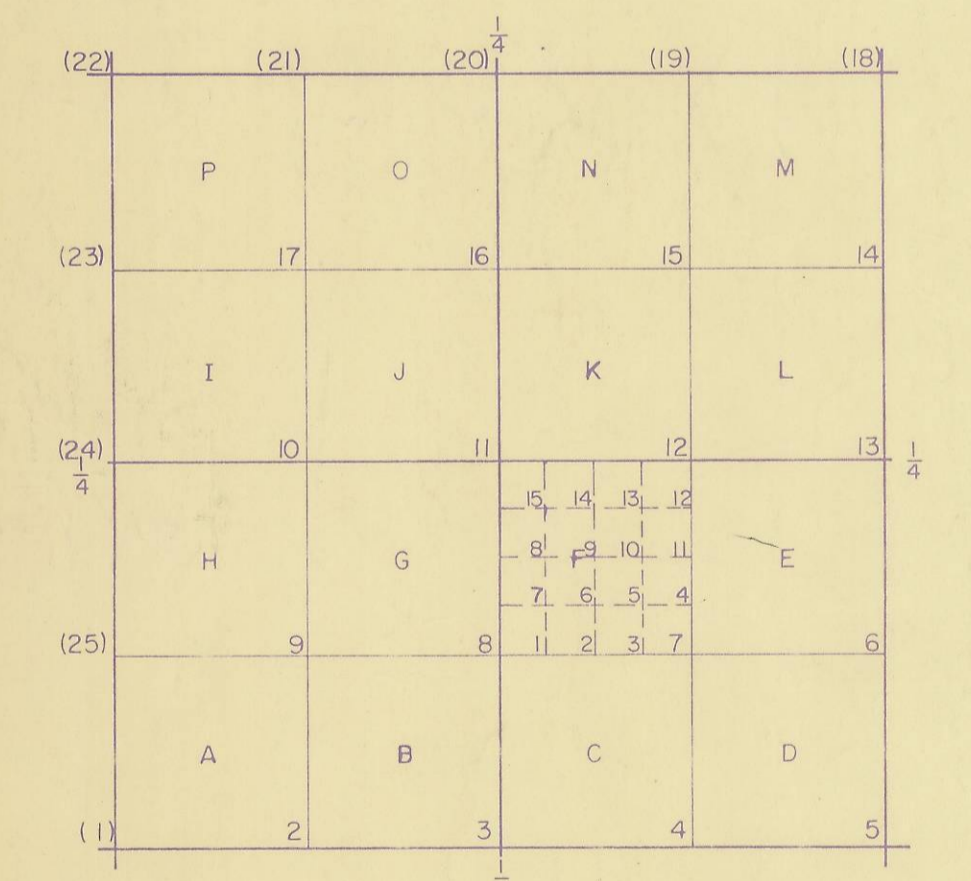

Section Corner Index Typical  
 ( ) - Special case  
 EXAMPLE:  
 18-3 = South 1/4 corner of Section 18  
 18-F-9 = Center of NW 1/4 of SE 1/4 of Section 18

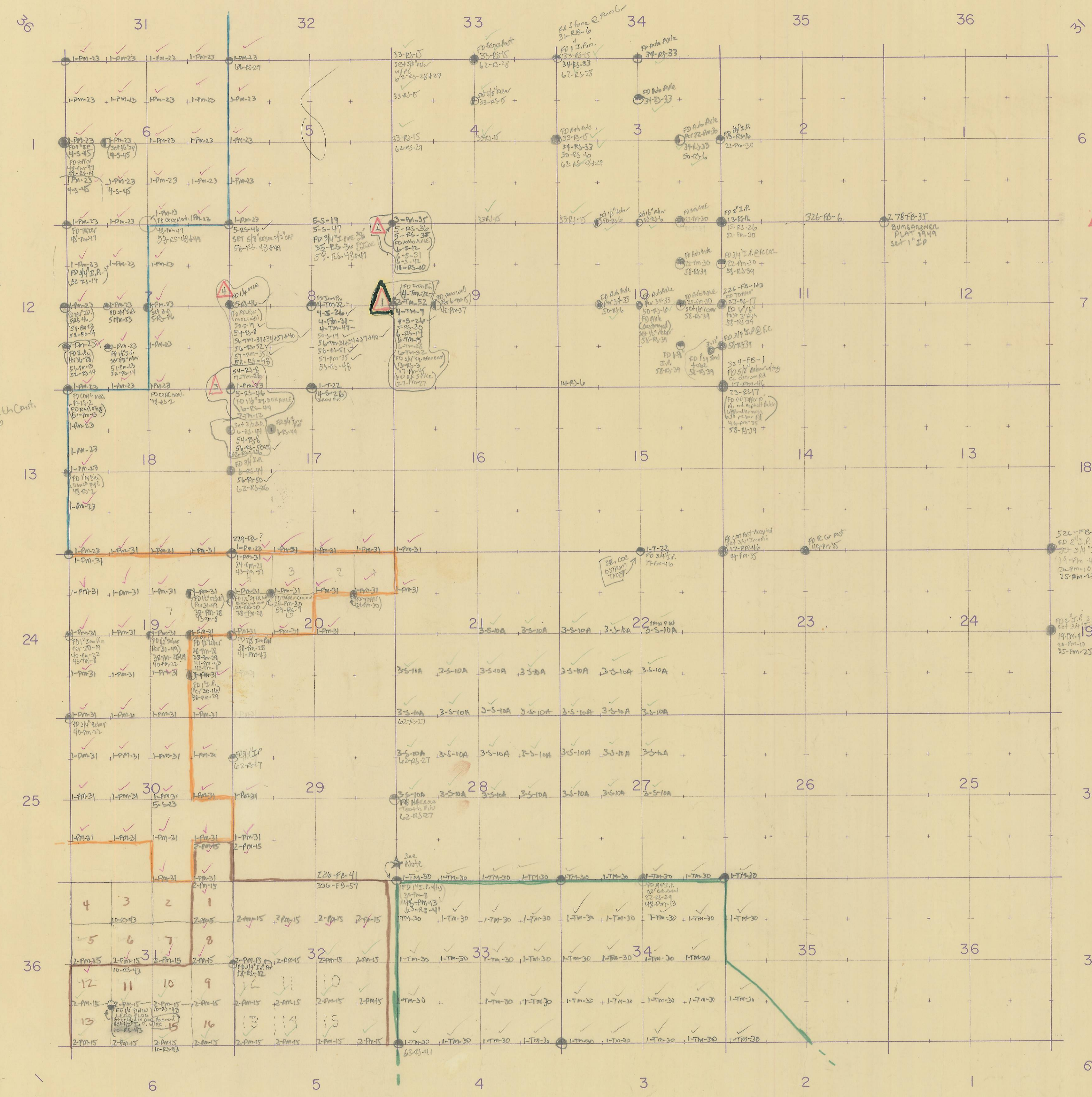

FD 141 Ayle 10 post well  
62-RS-26

FD 21 spike marked  
5/8-RS-51+52  
51-TM-35  
Ayle destroyed by alk. Cont.  
set 1/2" above w/ cap  
62-RS-26

Note:  
 man. destroyed by bridge  
 construction. Offset by  
 B.D. in point well by  
 de. measurements

- Farmstead Colony No 1 Boundary (1-23)
- Access Colony Boundary (1-31)
- HSBGA Colony No 2 Boundary (2-15)
- HARDING TRACT Boundary (1-30)

Date of last entry \_\_\_\_\_

**COUNTY OF YUBA**  
 DEPARTMENT OF PUBLIC WORKS

MARYSVILLE CALIFORNIA

Section Corner Monumentation  
 T. 14 N. - R. 4 E. - M.D.B. & M.

DWN. BY	DATE	PROJECT NUMBER
CHK. BY	DATE	
F.B.	SCALE 1" = 2000'	